

# The Pause

At Taman Wawasan, an old basketball frame is **repurposed** as a resting structure shaped by timber and tensile fabric. Positioned between a playground and an outdoor gym, it becomes a hub where parents watch over play, joggers pause, and the elderly catch their breath. Timber benches and a central table offer comfort beneath a stretched canopy, while soft dyed silks drift gently, adding movement, color, and identity. More than just a shelter, it frames moments of rest and connection—woven into the daily rhythm of the park.

## JOINERY DETAILS

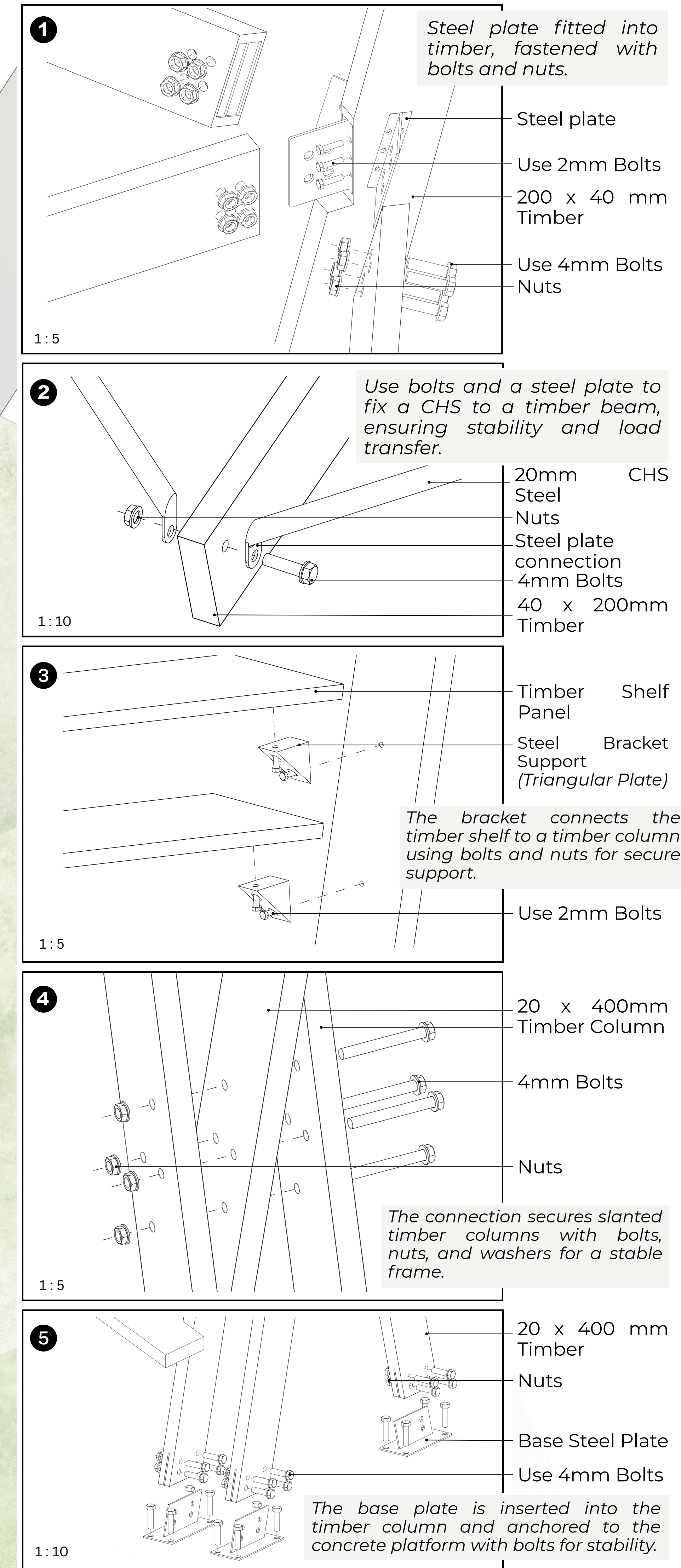

## EXPLODED AXONOMETRIC

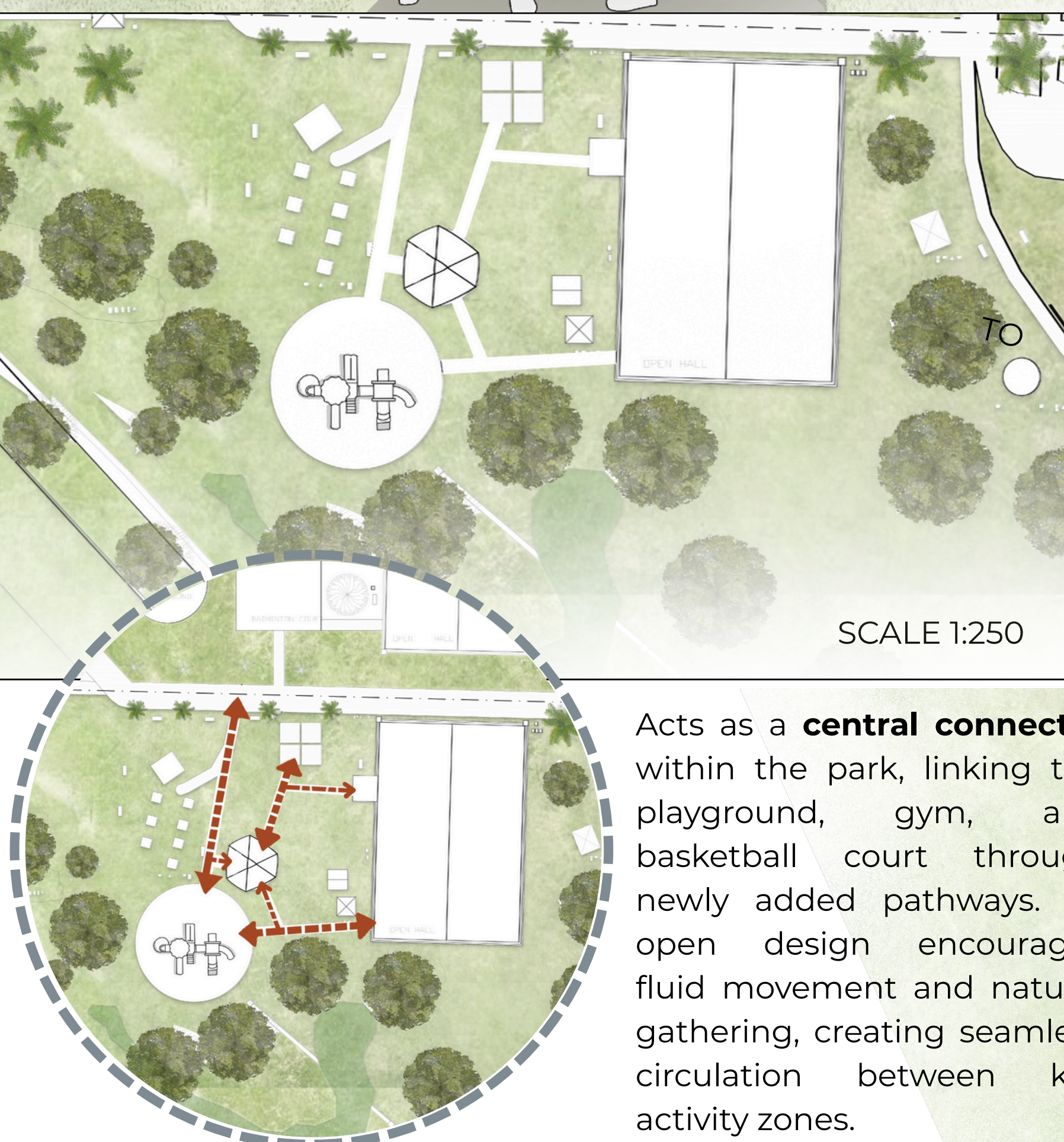
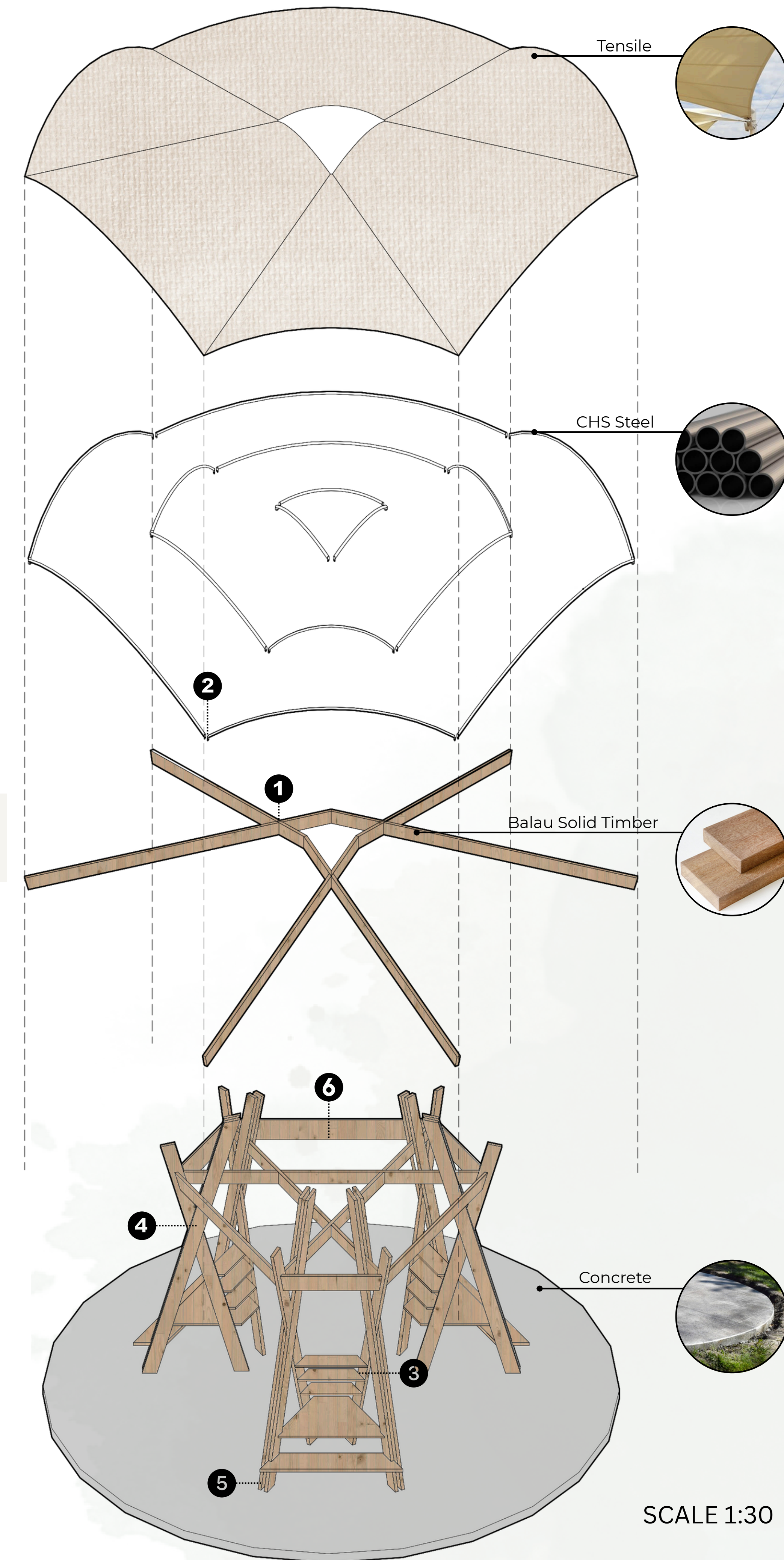

## FLOOR PLAN

SCALE 1:25

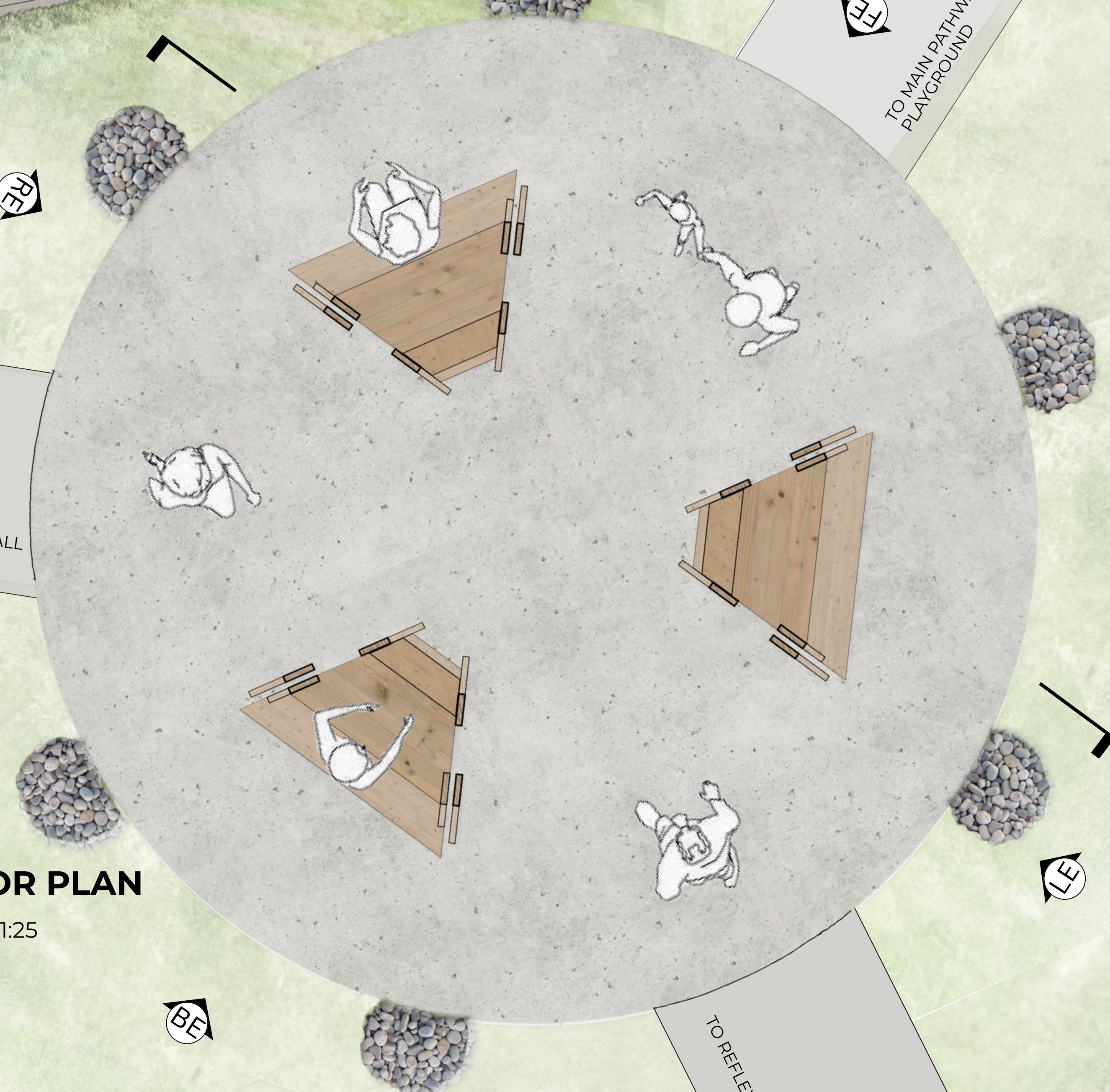

## USER EXPERIENCES DIAGRAMS

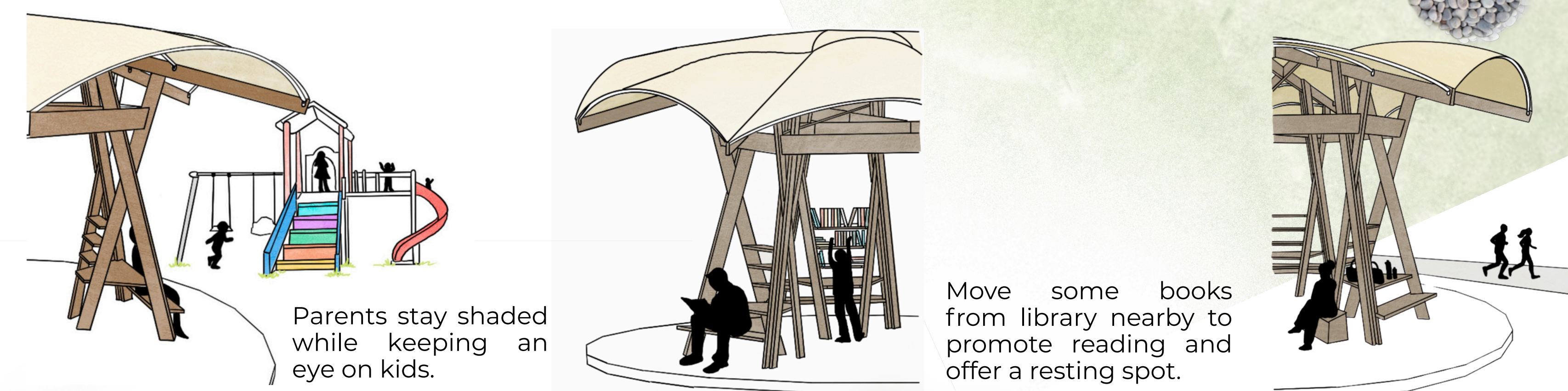

## ELEVATIONS

SCALE 1:50



## DETAILED SECTION

SCALE 1:25

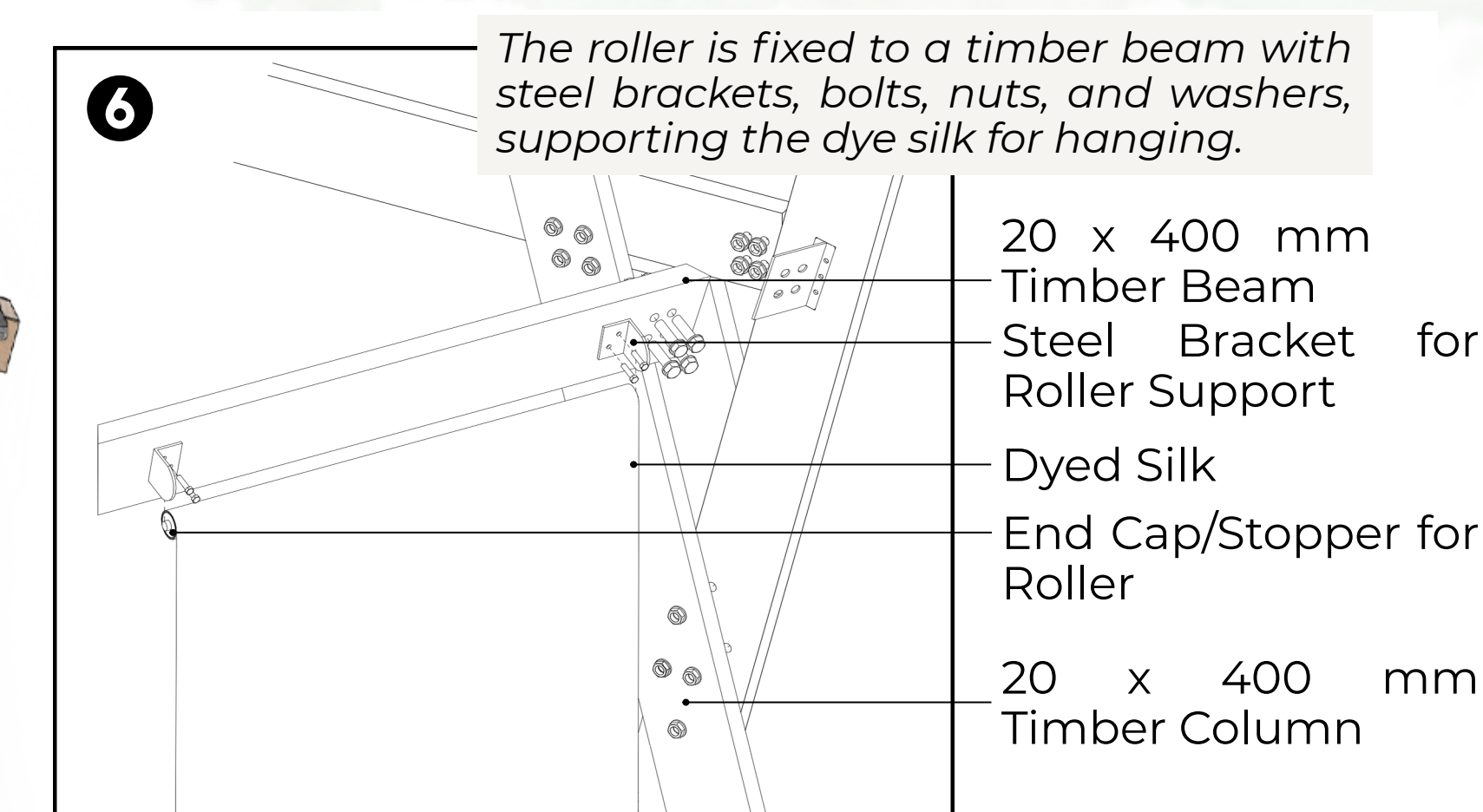
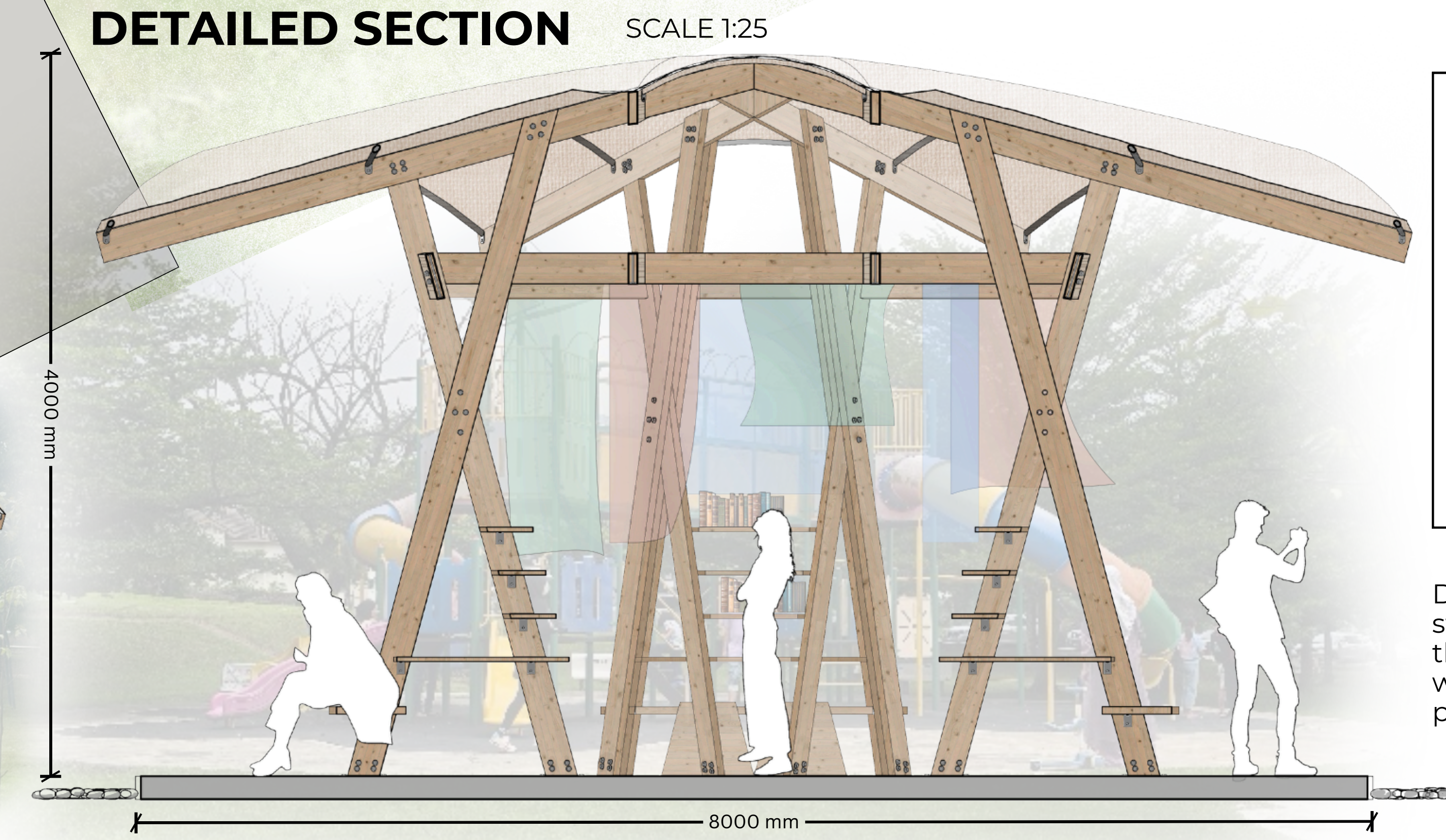

Dyed silk hang in the structure adding identity to the space, can be replaced with artworks for exhibition purpose.

